

ENGINE REAR OIL SEAL (3MZ-FE)

REPLACEMENT

1. REMOVE AUTOMATIC TRANSAXLE ASSY (2WD TYPE) (See page 40-20)
2. REMOVE AUTOMATIC TRANSAXLE W/TRANSFER (4WD TYPE) (See page 40-20)

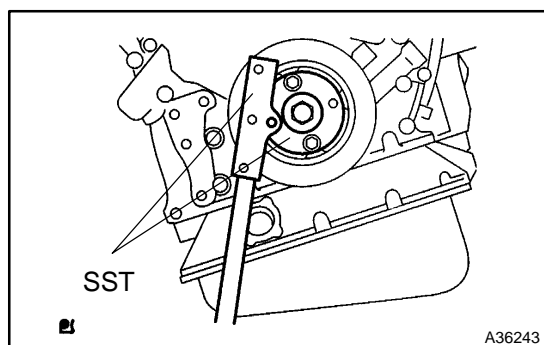

3. REMOVE DRIVE PLATE & RING GEAR SUB-ASSY

- (a) Using SST, hold the crankshaft.
SST 09213-54015 (91651-60855), 09330-00021

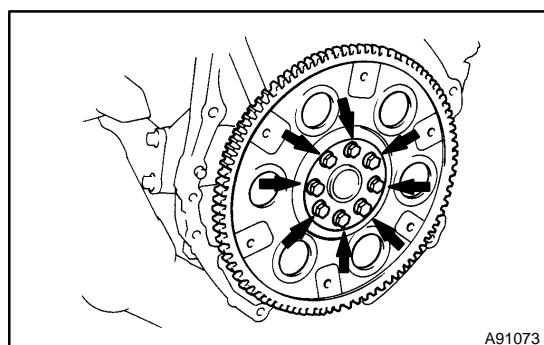

- (b) Remove the 8 bolts, the rear spacer, the drive plate and the front spacer.

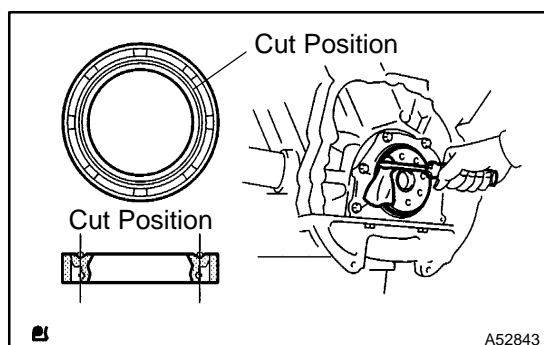

4. REMOVE ENGINE REAR OIL SEAL

- (a) Using a knife, cut off the oil seal lip.
- (b) Using a screwdriver with its tip wrapped in tape, pry out the oil seal.

NOTICE:

After the removal, check if the crankshaft is not damaged. If it is damaged, smooth the surface with 400-grit sandpaper.

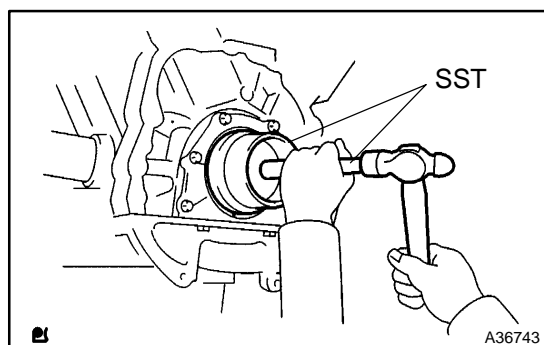

5. INSTALL ENGINE REAR OIL SEAL

- (a) Apply MP grease to a new oil seal lip.

NOTICE:

Keep the lip off foreign materials.

- (b) Using SST and a hammer, tap in the oil seal until its surface is flush with the rear oil seal retainer edge.

SST 09223-15030, 09950-70010 (09951-07100)

NOTICE:

- Be careful not to tap the oil seal at an angle.
- Wipe off extra grease from the crankshaft.

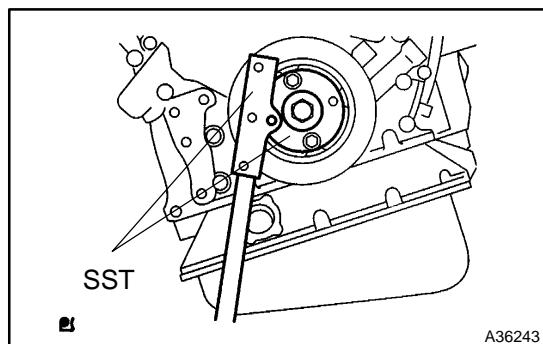

6. INSTALL DRIVE PLATE & RING GEAR SUB-ASSY

- (a) Using SST, hold the crankshaft.
SST 09213-54015 (91651-60855), 09330-00021
- (b) Clean the bolts and bolt holes.
- (c) Apply adhesive to 2 or 3 threads of the bolts.

Adhesive:

Part No. 08833-00070, THREE BOND 1324 or equivalent

- (d) Install the front spacer, the drive plate and the rear spacer on the crankshaft.
- (e) Uniformly install and tighten the 8 bolts in the sequence shown in the illustration.

Torque: 83 N·m (846 kgf·cm, 61 ft·lbf)

NOTICE:

Do not start the engine for at least an hour after installing.

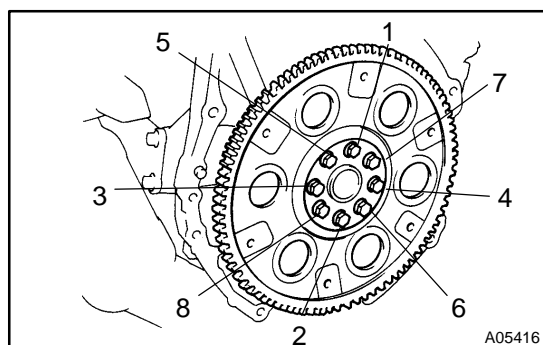

7. INSTALL AUTOMATIC TRANSAXLE W/TRANSFER (4WD TYPE) (See page 40-20)

8. INSTALL AUTOMATIC TRANSAXLE ASSY (2WD TYPE) (See page 40-20)