

REPLACEMENT

NOTICE:

Before changing the starter, check the following again:

- Connector connection
- Accessory installation

1. REMOVE BATTERY
2. REMOVE BATTERY TRAY

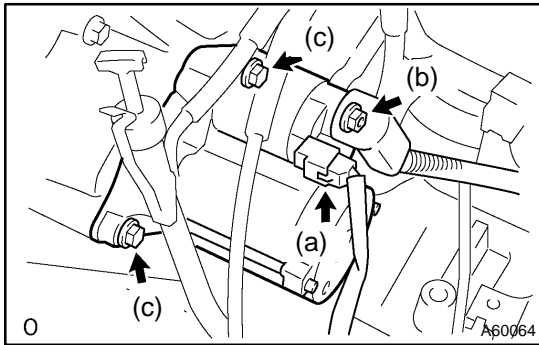

3. REMOVE STARTER ASSY

- (a) Disconnect the starter connector.
- (b) Open the terminal cap, remove the nut and disconnect the starter wire.
- (c) Remove the 2 bolts and starter.

4. INSTALL STARTER ASSY

- (a) Install the starter with the 2 bolts.
Torque: 37 N·m (377 kgf·cm, 27 ft·lbf)
- (b) Install the starter wire with the nut.
Torque: 9.8 N·m (100 kgf·cm, 7 ft·lbf)
- (c) Connect the starter connector.

5. INSTALL BATTERY TRAY

6. INSTALL BATTERY

- (a) Install the battery clamp with the bolt and nut.
Torque: 5.5 N·m (56 kgf·cm, 49 in·lbf)
- (b) Connect the cables to the battery terminals.
Torque: 3.5 N·m (36 kgf·cm, 31 in·lbf)