

REAR AXLE CARRIER SUB-ASSY LH (FF)

REPLACEMENT

300OM-02

HINT:

COMPONENTS: SEE PAGE 30-4

Replace the RH side by the same procedures with the LH side.

1. **REMOVE REAR WHEEL**
2. **SEPARATE REAR DISC BRAKE CALIPER ASSY LH**
3. **REMOVE REAR DISC (SEE PAGE 32-29)**
4. **DISCONNECT SKID CONTROL SENSOR**
 - (a) Disconnect the connector.
5. **REMOVE REAR AXLE HUB & BEARING ASSY LH**
6. **SEPARATE STRUT ROD ASSY REAR**

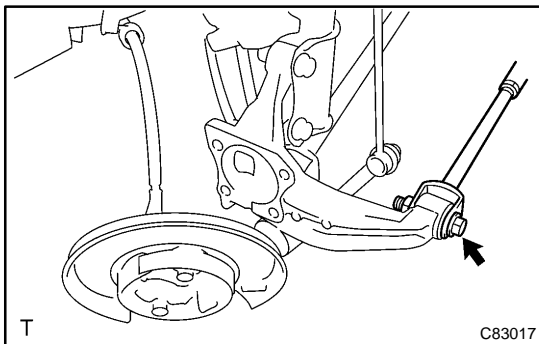

7. SEPARATE REAR SUSPENSION ARM ASSY NO.2 LH

- (a) Remove the bolt, nut and rear suspension arm No. 2 from the rear axle carrier.

HINT:

While fixing the nut, turn and remove the bolt.

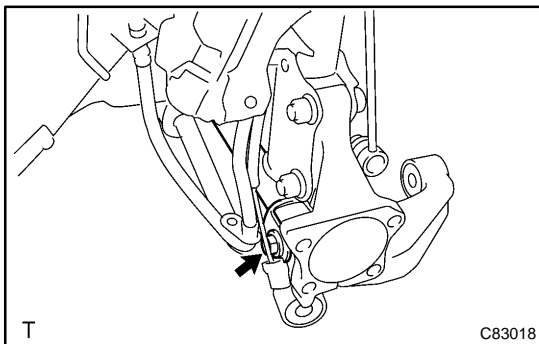

8. SEPARATE REAR SUSPENSION ARM ASSY NO.1 LH

- (a) Remove the bolt, nut and rear suspension arm No. 1 from the rear axle carrier.

HINT:

While fixing the nut, turn and remove the bolt.

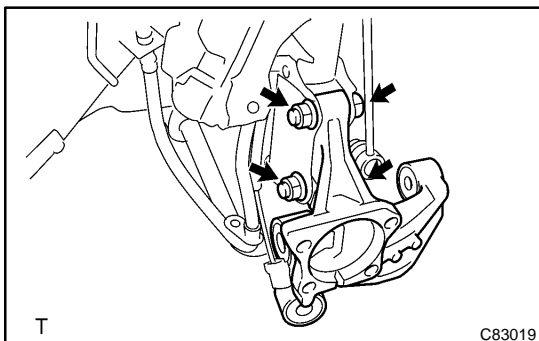

9. REMOVE REAR AXLE CARRIER SUB-ASSY LH

- (a) Remove the 2 bolts, nuts and rear axle carrier from the shock absorber.

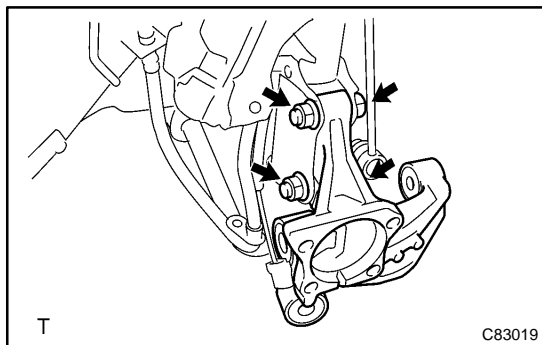
**10. INSTALL REAR AXLE CARRIER SUB-ASSY LH**

- (a) Install the rear axle carrier with the 2 bolts and nuts.

Torque: 180 N·m (1,840 kgf·cm, 133 ft·lbf)

HINT:

Insert the bolt from the rear side of the vehicle and install the nut.

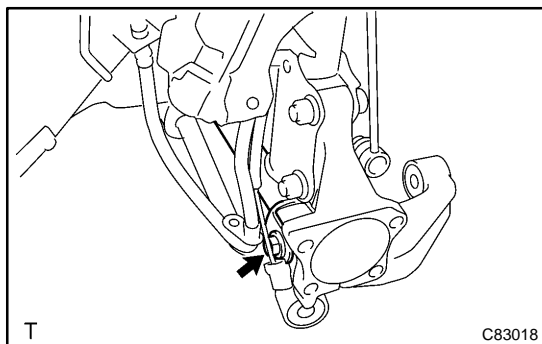
**11. TEMPORARILY TIGHTEN REAR SUSPENSION ARM ASSY NO.1 LH**

- (a) Install the rear suspension arm No. 1 to the rear axle carrier with the bolt and nut, temporarily tighten the bolt.

HINT:

Insert the bolt from the front side of the vehicle and while fixing the nut, turn and install the bolt.

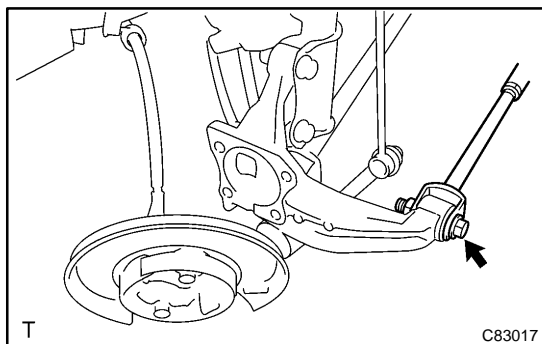
**12. TEMPORARILY TIGHTEN REAR SUSPENSION ARM ASSY NO.2 LH**

- (a) Install the rear suspension arm No. 2 to the rear axle carrier with the bolt and nut, temporarily tighten the bolt.

HINT:

Insert the bolt from the rear side of the vehicle and while fixing the nut, turn and install the bolt.

13. TEMPORARILY TIGHTEN STRUT ROD ASSY REAR (SEE PAGE 27-13)**14. INSTALL REAR AXLE HUB & BEARING ASSY LH (SEE PAGE 30-53)****15. INSPECT BEARING BACKLASH (SEE PAGE 30-3)****16. INSPECT AXLE HUB DEVIATION (SEE PAGE 30-3)****17. CONNECT SKID CONTROL SENSOR**

- (a) Connect the connector.

NOTICE:

Do not twist the sensor wire when connecting it.

18. INSTALL REAR DISC (SEE PAGE 32-29)**19. INSTALL REAR DISC BRAKE CALIPER ASSY LH (SEE PAGE 30-53)****20. INSTALL REAR WHEEL**

Torque: 103 N·m (1,050 kgf·cm, 76 ft·lbf)

21. STABILIZE SUSPENSION (SEE PAGE 27-27)**22. FULLY TIGHTEN REAR SUSPENSION ARM ASSY NO.1 LH (SEE PAGE 27-16)****23. FULLY TIGHTEN REAR SUSPENSION ARM ASSY NO.2 LH (SEE PAGE 27-23)****24. FULLY TIGHTEN STRUT ROD ASSY REAR (SEE PAGE 27-13)****25. INSPECT AND ADJUST REAR WHEEL ALIGNMENT (SEE PAGE 27-5)****26. CHECK ABS SPEED SENSOR SIGNAL (SEE PAGE 05-765)**