

# SKID CONTROL SENSOR (FF)

## REPLACEMENT

### HINT:

- Use the same procedures for the RH side and LH side.
  - The procedures listed below are for the LH side.
1. **REMOVE REAR WHEEL**
  2. **DISCONNECT SKID CONTROL SENSOR WIRE**
  - (a) Disconnect the connector from the skid control sensor.
  3. **SEPARATE REAR DISC BRAKE CALIPER ASSY LH (SEE PAGE 30-53 )**
  4. **REMOVE REAR DISC (SEE PAGE 30-53 )**
  5. **REMOVE REAR AXLE HUB & BEARING ASSY LH (SEE PAGE 30-53 )**

### 6. REMOVE SKID CONTROL SENSOR

- (a) Mount the hub & bearing assy on a soft jaw vise.

#### NOTICE:

**Replace the hub & bearing assy if it is dropped or receives a strong shock.**

- (b) Using a pin punch and hammer, drive out the 2 pins and remove the 2 attachments from SST.

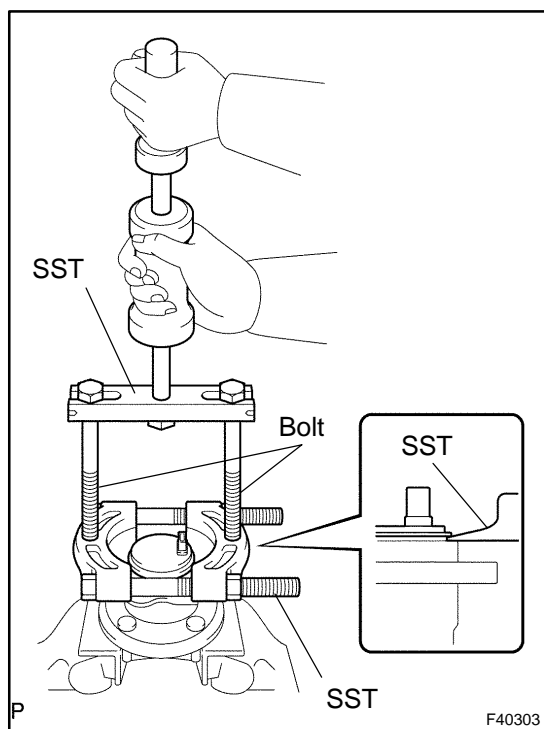

- (c) Using SST and 2 bolts (Diameter: 12 mm, pitch: 1.5 mm), remove the skid control sensor from the hub & bearing assy.

SST 09520-00031 (09520-00040), 09521-00020, 09950-00020

#### NOTICE:

- **If damage is inflicted to the sensor rotor, replace the hub & bearing assy.**
- **Do not scratch the contacting surface of the hub & bearing assy and the skid control sensor.**

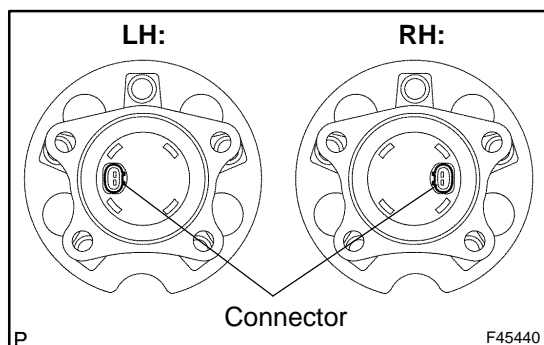

### 7. INSTALL SKID CONTROL SENSOR

- (a) Clean the contacting surface of the rear axle hub and a assy and a new skid control sensor.

#### NOTICE:

**Prevent foreign matter from attaching to the sensor rotor.**

- (b) Place the skid control sensor on the rear axle hub so that the connector makes the lowest position under the on-vehicle condition.

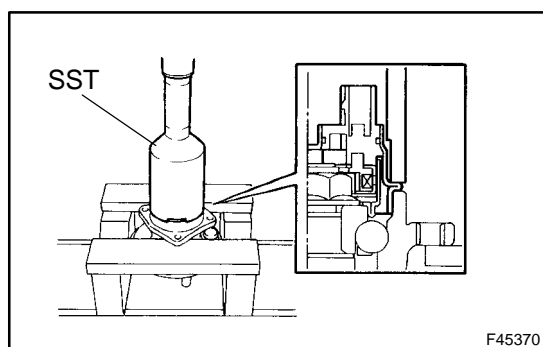

- (c) Using SST and a press, install the skid control sensor onto the hub & bearing assy.

SST 09214-7601 1

**NOTICE:**

- Do not tap the skid control sensor with a hammer directly.
- Check that there is no foreign matter on the skid control sensor detection portion.
- Press in the skid control sensor straight and slowly.

8. **INSTALL REAR AXLE HUB & BEARING ASSY LH (SEE PAGE 30-53 )**

9. **INSPECT BEARING BACKLASH (SEE PAGE 30-53 )**

10. **INSPECT AXLE HUB DEVIATION (SEE PAGE 30-53 )**

11. **INSTALL REAR DISC (SEE PAGE 30-53 )**

12. **INSTALL REAR DISC BRAKE CALIPER ASSY LH (SEE PAGE 30-53 )**

13. **CONNECT SKID CONTROL SENSOR WIRE**

- (a) Connect the connector to the skid control sensor.

14. **INSTALL REAR WHEEL**

Torque: 103 N·m (1,050 kgf·cm, 76 ft·lbf)

15. **INSPECT AND ADJUST REAR WHEEL ALIGNMENT (SEE PAGE 27-5 )**

16. **CHECK ABS SPEED SENSOR SIGNAL (SEE PAGE 05-765 )**