

TRANSMISSION VALVE BODY ASSY (U241E/U140F)

40064-06

REPLACEMENT

1. REMOVE ENGINE UNDER COVER NO.1

2. DRAIN AUTOMATIC TRANSAXLE FLUID

- (a) Remove the drain plug, gasket and drain ATF.
- (b) Install a new gasket and drain plug.

Torque: 49 N·m (500 kgf·cm, 36 ft·lbf)

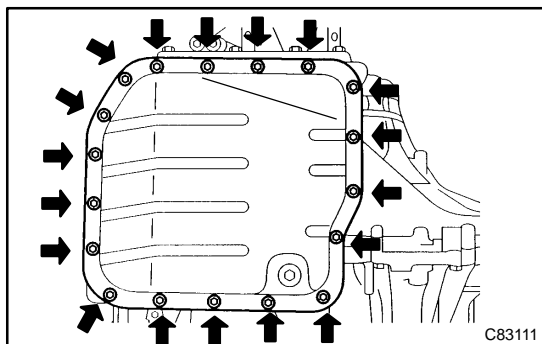

3. REMOVE AUTOMATIC TRANSAXLE OIL PAN SUB-ASSY

- (a) Remove the 18 bolts, oil pan and gasket.

NOTICE:

Some fluid will remain in the oil pan. Remove all pan bolts, and carefully remove the oil pan assembly. Discard the gasket.

- (b) Remove the 2 magnets from the oil pan.

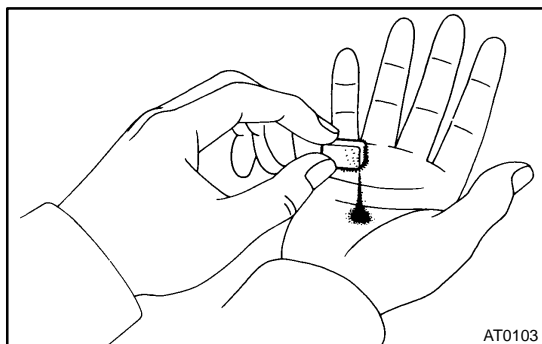

- (c) Examine particles in pan.

- (1) Remove the magnets and use them to collect any steel chips. Look carefully at the chips and particles in the pan and the magnet to anticipate what type of wear you will find in the transaxle.
Steel (magnetic): bearing, gear and plate wear
Brass (non-magnetic): bearing wear

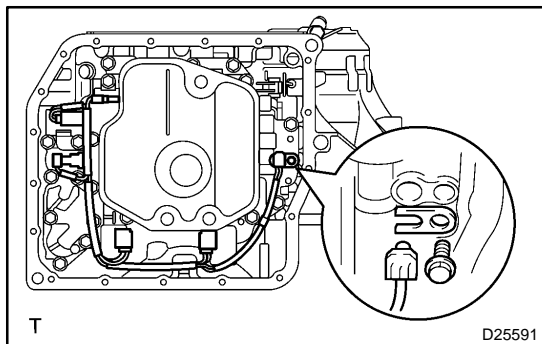

4. SEPARATE TRANSMISSION WIRE

- (a) Disconnect the 5 connectors.
- (b) Remove the bolt and lock plate, and remove the ATF temperature sensor.

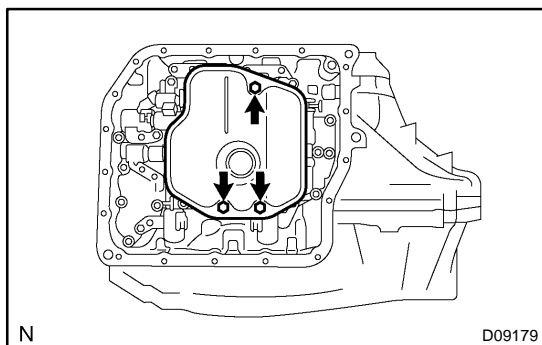

5. REMOVE VALVE BODY OIL STRAINER ASSY

- (a) Remove the 3 bolts and oil strainer.

NOTICE:

Be careful as some fluid will come out with the oil strainer.

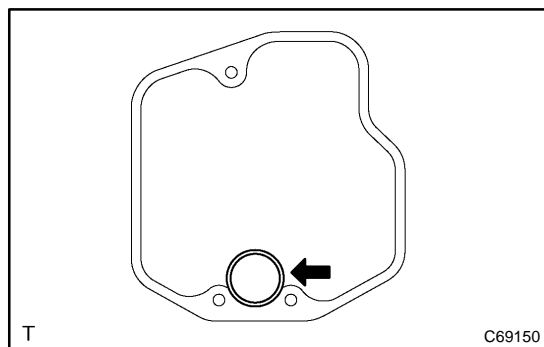

- (b) Remove the O-ring from the oil strainer.

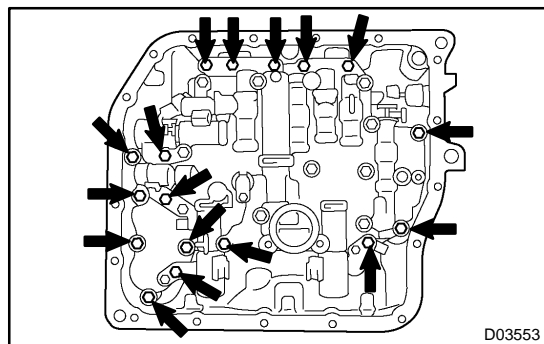

6. REMOVE TRANSMISSION VALVE BODY ASSY

- (a) Support the valve body assy and remove the 17 bolts and the valve body assy.

NOTICE:

Be careful not to drop the check valve body, spring and accumulator piston.

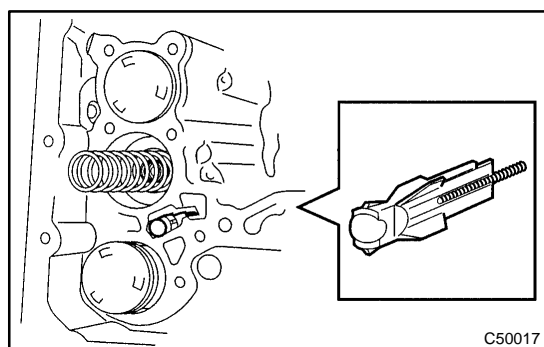

- (b) Remove the check ball body and spring.

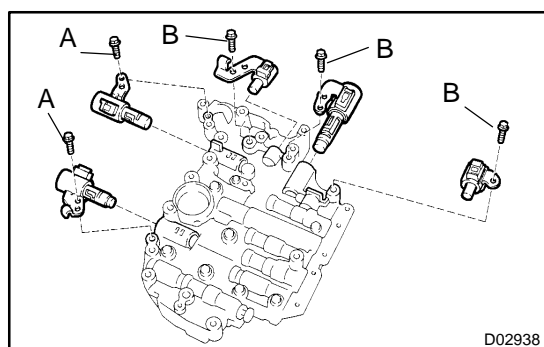

- (c) Remove the 5 bolts and 5 shift solenoid valves.

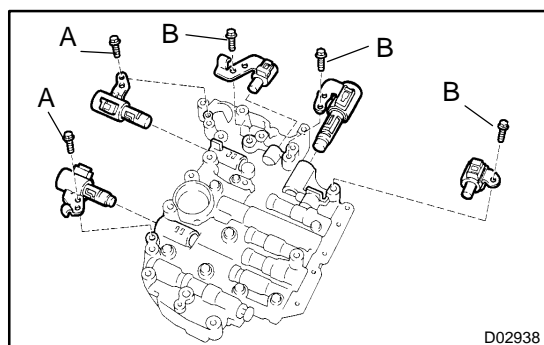

7. INSTALL TRANSMISSION VALVE BODY ASSY

- (a) Install the 5 shift solenoid valves with the 5 bolts.

Torque:

6.6 N·m (67 kgf·cm, 58 in·lbf) for Bolt A

11 N·m (112 kgf·cm, 8 ft·lbf) for Bolt B

Bolt length:

12 mm (0.47 in.) for Bolt A

45 mm (1.77 in.) for Bolt B

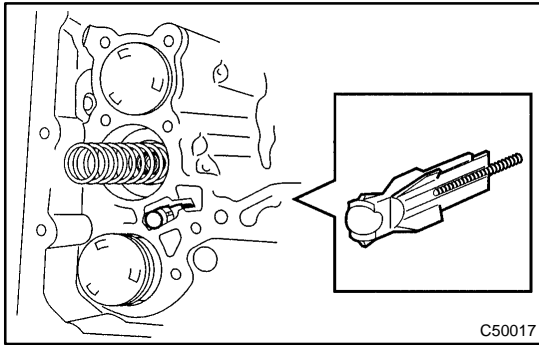

- (b) Install the spring and check ball body.

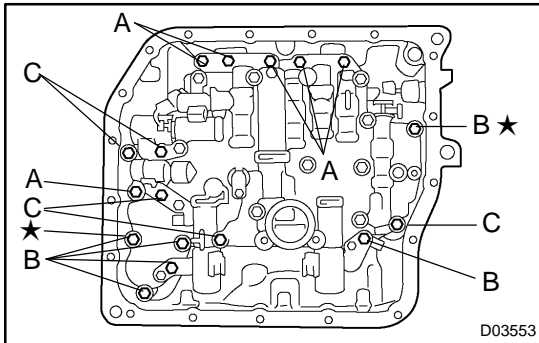

- (c) Align the groove of the manual valve with the pin of lever.
(d) Install the 17 bolts.

Torque: 11 N·m (110 kgf·cm, 8 ft·lbf)

NOTICE:

- Push the valve body against the accumulator piston spring and the check ball body to install it.
- Tighten those bolts marked by ★ in the illustration first temporarily because they are positioning bolts.

Bolt length:

25 mm (0.984 in.) for Bolt A

41 mm (1.614 in.) for Bolt B

45 mm (1.771 in.) for Bolt C

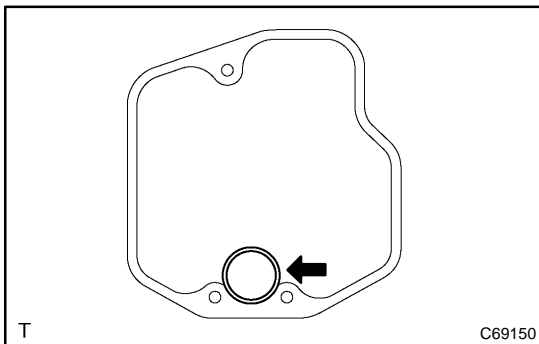

8. INSTALL VALVE BODY OIL STRAINER ASSY

- (a) Coat a new O-ring with ATF.
(b) Install the O-ring to the oil strainer.

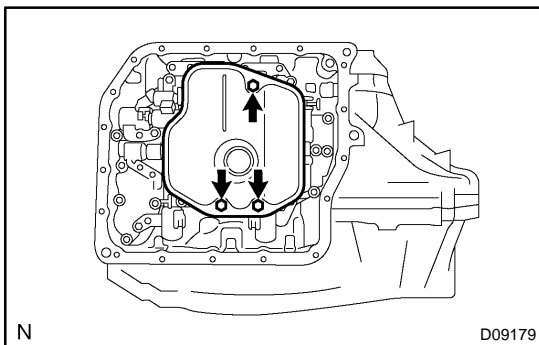

- (c) Install the oil strainer with the 3 bolts.
Torque: 11 N·m (110 kgf·cm, 8 ft·lbf)

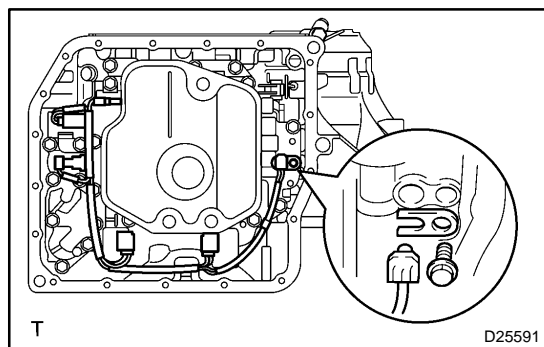

9. INSTALL TRANSMISSION WIRE

- (a) Coat a O-ring with ATF.
- (b) Install the ATF temperature sensor with the lock plate and bolt.
Torque: 6.6 N·m (67 kgf·cm, 58 in.-lbf)
- (c) Connect the 5 shift solenoid valve connectors.

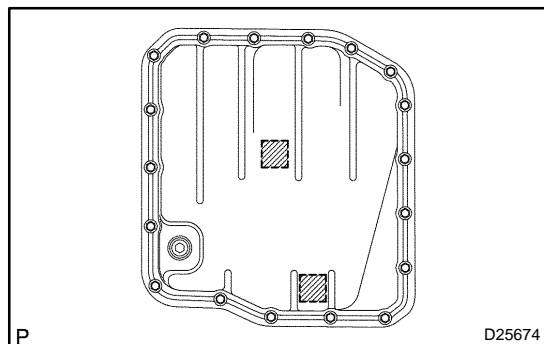

10. INSTALL AUTOMATIC TRANSAXLE OIL PAN SUB-ASSY

- (a) Install the 2 magnets in the oil pan.
- (b) Apply seal packing or equivalent to 18 bolts.
Seal packing:
THREE BOND 2430 or equivalent

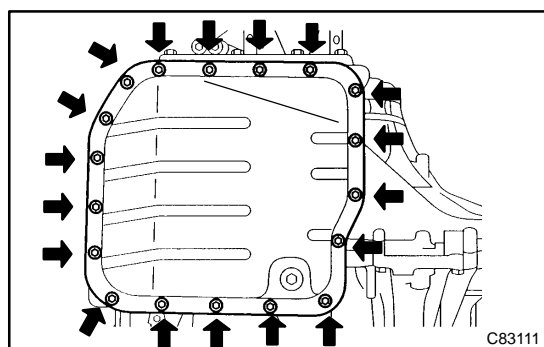

- (c) Install a new gasket, oil pan and 18 bolts to the transaxle case.

Torque: 7.6 N·m (77 kgf·cm, 67 in.-lbf)

NOTICE:

Because the bolts should be seal bolts, apply seal packing to bolts and tighten them within 10 minutes after application.

11. ADD AUTOMATIC TRANSAXLE FLUID

12. INSPECT AUTOMATIC TRANSAXLE FLUID (SEE PAGE 40-2)