

## OVERHAUL

### HINT:

- The installation procedures are the removal procedures in reverse order. However, only installation procedures requiring additional information are included.
  - A bolt without a torque specification is shown in the standard bolt chart (see page 03-2 ).
1. **REMOVE TONNEAU COVER ASSY (W/ TONNEAU COVER) (See page 76-21 )**
  2. **REMOVE DECK BOARD SUB-ASSY NO.2 (See page 76-21 )**
  3. **REMOVE DECK BOARD SUB-ASSY NO.3 (See page 76-21 )**
  4. **REMOVE DECK BOARD SUB-ASSY (See page 76-21 )**
  5. **REMOVE DECK FLOOR BOX REAR (See page 76-21 )**
  6. **REMOVE DECK SIDE TRIM BOX LH (See page 76-21 )**
  7. **REMOVE DECK SIDE TRIM BOX RH (See page 76-21 )**
  8. **REMOVE DECK BOARD BRACKET REINFORCEMENT (See page 76-21 )**
  9. **REMOVE RECLINING PEDAL COVER LH**
    - (a) Remove the screw and reclining pedal cover LH.
  10. **REMOVE RECLINING PEDAL COVER RH**

### HINT:

Use the same procedures described for the LH side.

11. **REMOVE REAR SEAT RECLINING COVER NO.2 LH**
  - (a) Remove the 2 screws and rear seat reclining cover No. 2 LH.
12. **REMOVE REAR SEAT RECLINING COVER NO.2 RH**

### HINT:

Use the same procedures described for the LH side.

13. **REMOVE REAR SEAT RECLINING COVER INNER LH**
  - (a) Remove the screw and rear seat reclining cover inner LH.
14. **REMOVE REAR SEAT RECLINING COVER INNER RH**

### HINT:

Use the same procedures described for the LH side.

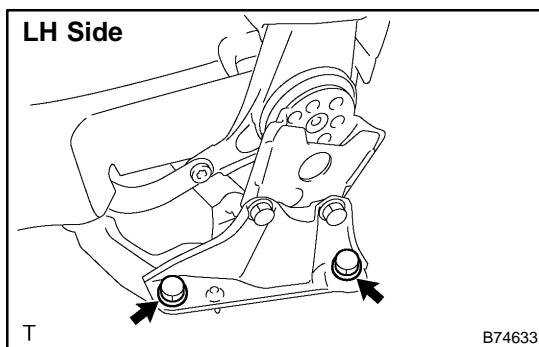

15. **REMOVE REAR NO.2 SEAT ASSY**
  - (a) Remove the 4 bolts and rear No. 2 seat.

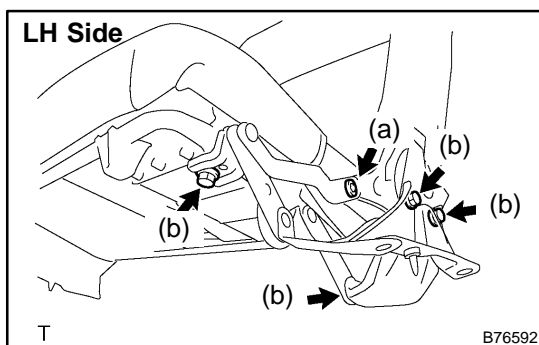

16. **REMOVE REAR NO.2 SEAT LEG LH**
  - (a) Using a torx® socket wrench (T45), remove the sub seat bolt.
  - (b) Remove the 4 bolts and rear No. 2 seat leg LH.
17. **REMOVE REAR NO.2 SEAT LEG RH**

### HINT:

Use the same procedures described for the LH side.

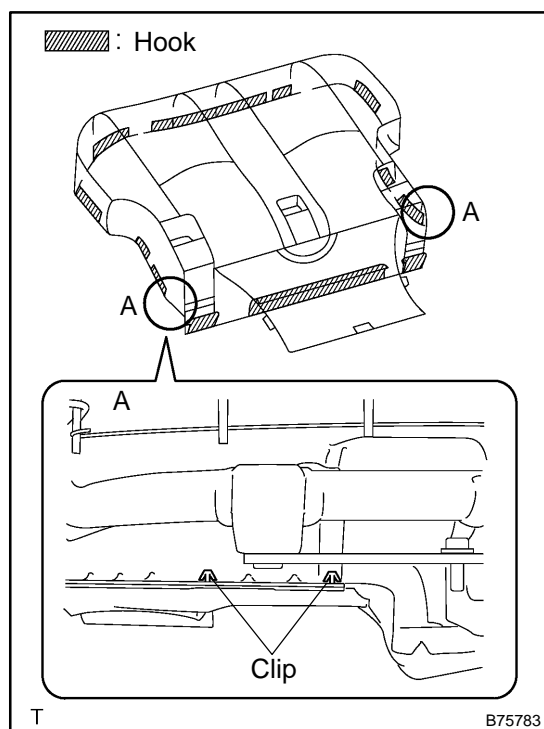
**18. REMOVE NO.2 SEAT CUSHION COVER SUB-ASSY**

- Remove the 4 clips and hook.
- Remove the hog rings and seat cushion cover together with the pad from the seat cushion frame.
- Remove the hog rings and seat cushion cover from the seat cushion pad.

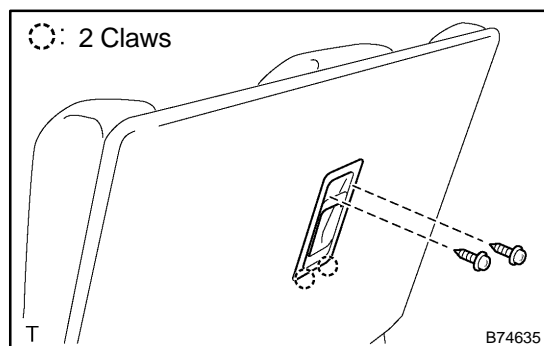
**19. REMOVE REAR SEAT HEADREST ASSY****20. REMOVE HANDLE 3RD SEAT**

- Remove the 2 screws.
- Disengage the 2 claws.
- Disconnect the rear No. 1 seat cable and remove the handle 3rd seat.

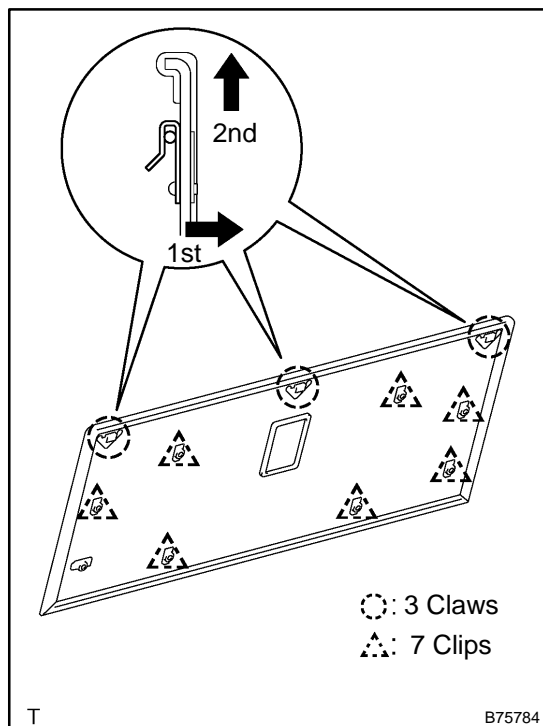
**21. REMOVE NO.2 SEATBACK BOARD ASSY**

- (a) Remove the 7 clips.
- (b) Disengage the 3 claws and remove the seatback board.

**22. REMOVE NO.2 SEATBACK COVER ASSY**

- (a) Remove the 2 headrest supports.
- (b) Remove the hog rings and seatback cover together with the pad from the seatback frame.
- (c) Remove the hog rings and seatback cover from the seatback pad.

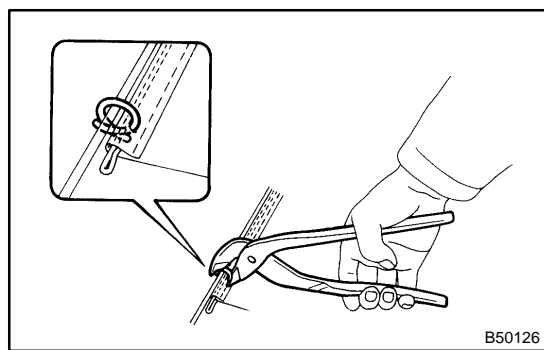
**23. REMOVE REAR SIDE SEAT BAND SUB-ASSY NO.2****24. REMOVE REAR SEAT COVER BEZEL NO.1****25. REMOVE REAR NO.1 SEAT LOCK CABLE ASSY****26. INSTALL REAR NO.1 SEAT LOCK CABLE ASSY****27. INSTALL REAR SEAT COVER BEZEL NO.1****28. INSTALL REAR SIDE SEAT BAND SUB-ASSY NO.2****29. INSTALL NO.2 SEATBACK COVER ASSY**

- (a) Install the seatback cover to the seatback pad with new hog rings.
- (b) Install the seatback cover with the pad to the seatback frame with new hog rings.

**HINT:**

When installing hog rings, take care to prevent wrinkles as little as possible.

**30. INSTALL NO.2 SEATBACK BOARD ASSY****31. INSTALL HANDLE 3RD SEAT****32. INSTALL REAR SEAT HEADREST ASSY**

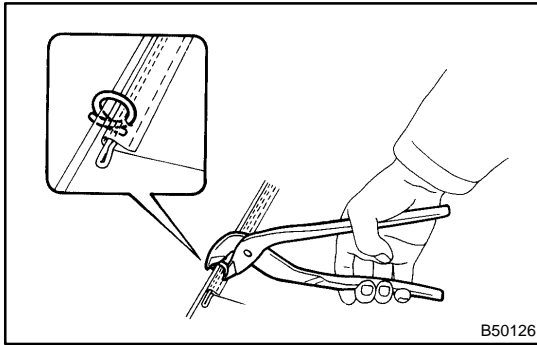

### 33. INSTALL NO.2 SEAT CUSHION COVER SUB-ASSY

- (a) Install the seat cushion cover to the seat cushion pad with new hog rings.
- (b) Install the seat cushion cover with the pad to the seat cushion frame with new hog rings.

#### HINT:

When installing the hog rings, take care to prevent wrinkles as much as possible.

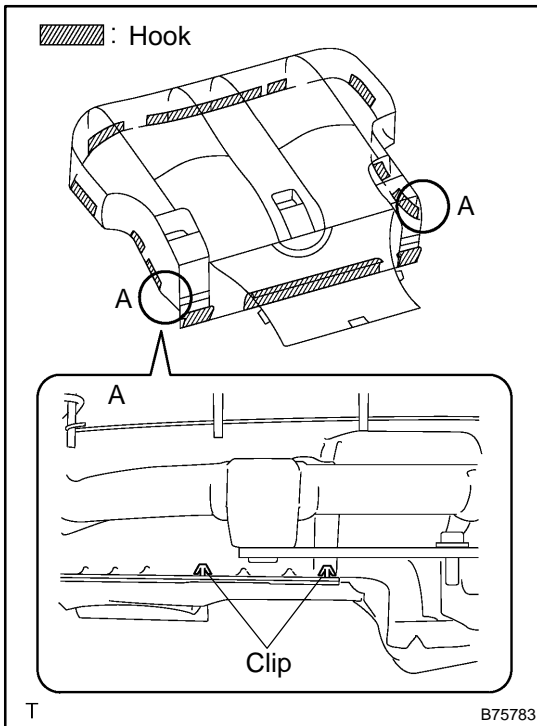

- (c) Install the 4 clips and hook.

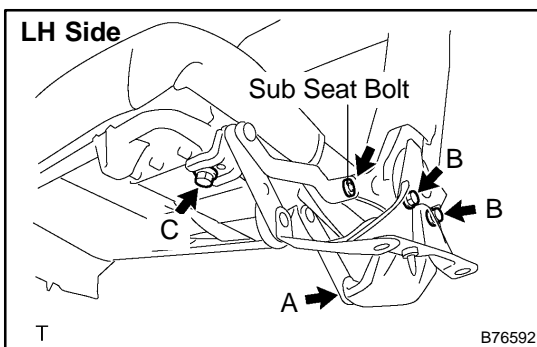

### 34. INSTALL REAR NO.2 SEAT LEG LH

- (a) Install the rear No. 2 seat leg LH with the sub seat bolt and 4 bolts.

#### Torque:

21 N·m (214 kgf·cm, 15 ft·lbf) for bolt A

42 N·m (428 kgf·cm, 31 ft·lbf) for bolt B

18 N·m (184 kgf·cm, 13 ft·lbf) for bolt C

### 35. INSTALL REAR NO.2 SEAT LEG RH

#### HINT:

Use the same procedures described for the LH side.

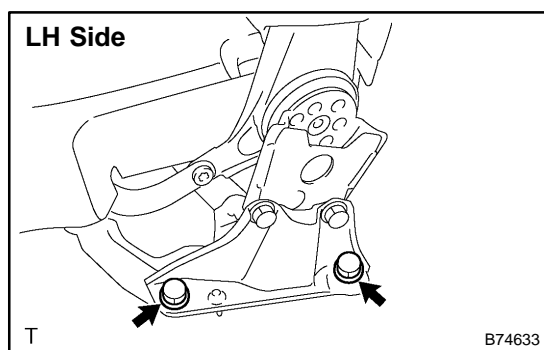
**36. INSTALL REAR NO.2 SEAT ASSY**

- (a) Install the rear No. 2 seat with the 4 bolts.

**Torque: 37 N·m (377 kgf·cm, 27 ft·lbf)**