

INSPECTION

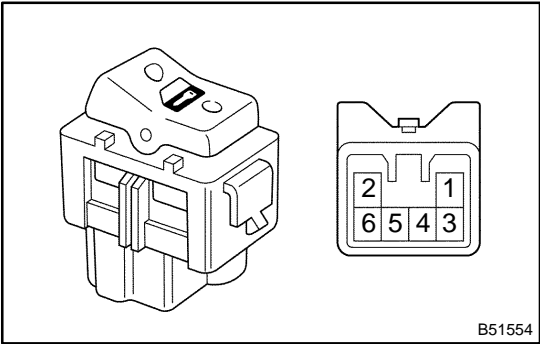

1. INSPECT DOOR CONTROL SWITCH ASSY

(a) Inspect the door control switch continuity.

Switch position	Tester connection	Specified condition
Lock	3 - 6	Continuity
OFF	-	No continuity
Unlock	3 - 5	Continuity

If the continuity is not as specified, replace the switch.

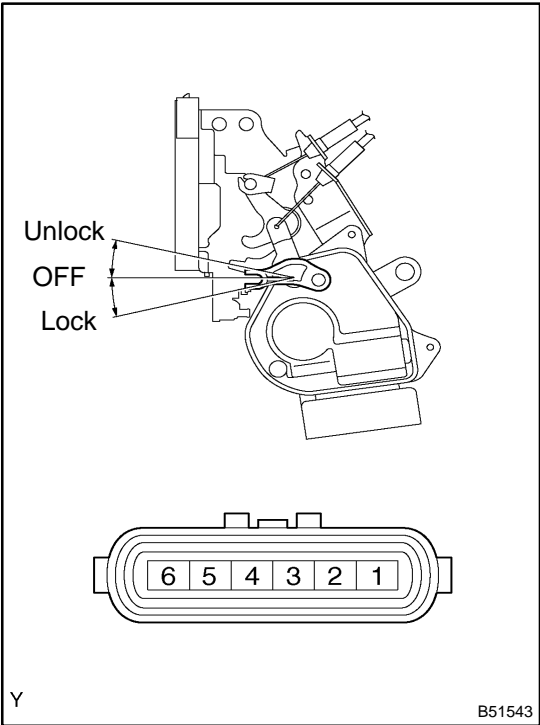

2. INSPECT FRONT DOOR LOCK ASSY RH

(a) Inspect the door lock assembly continuity.

Switch position	Tester connection	Specified condition
Lock	3 - 5	Continuity
OFF	-	No continuity
Unlock	4 - 5	Continuity

If the continuity is not as specified, replace the door lock assembly.

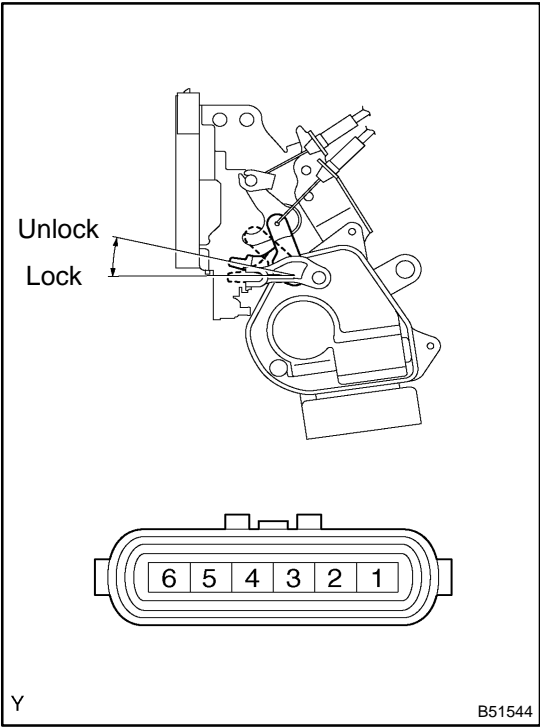

(b) Inspect operation of the door lock motor.

Measurement condition	Operation
Battery positive - Terminal 1 Battery negative - Terminal 2	Lock
Battery positive - Terminal 2 Battery negative - Terminal 1	Unlock

If operation is not as specified, replace the door lock assembly.

(c) Inspect the position switch continuity.

Measurement condition	Tester connection	Specified condition
Battery positive - Terminal 2 Battery negative - Terminal 1	5 - 6	Continuity

If the continuity is not as specified, replace the door lock assembly.

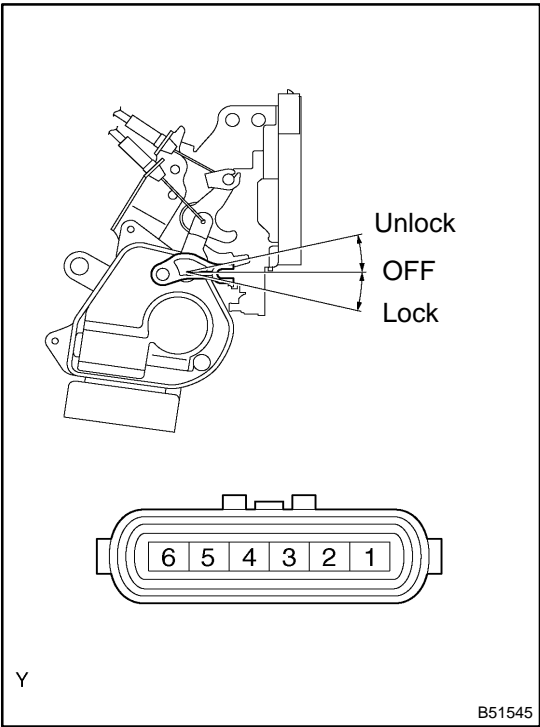

3. INSPECT FRONT DOOR LOCK ASSY LH

(a) Inspect the door lock assembly continuity.

Switch position	Tester connection	Specified condition
Lock	2 - 4	Continuity
OFF	-	No continuity
Unlock	2 - 3	Continuity

If the continuity is not as specified, replace the door lock assembly.

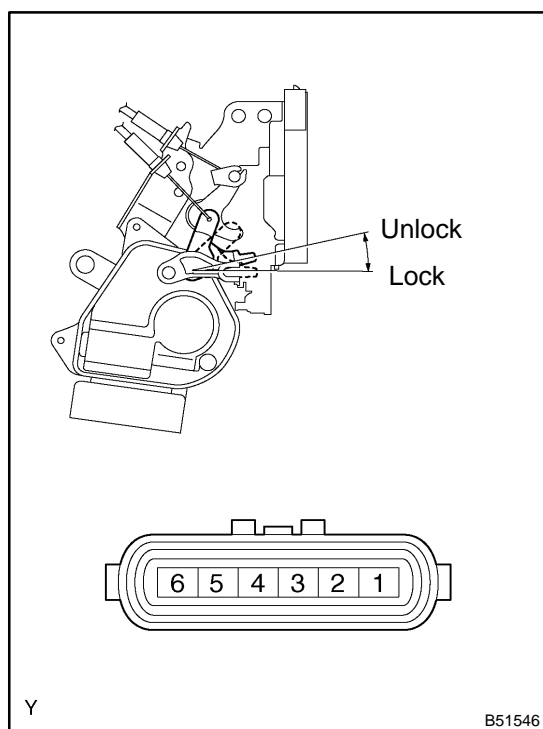

## (b) Inspect operation of the door lock motor.

Measurement condition	Operation
Battery positive - Terminal 5 Battery negative - Terminal 6	Lock
Battery positive - Terminal 6 Battery negative - Terminal 5	Unlock

If operation is not as specified, replace the door lock assembly.

## (c) Inspect the position switch continuity.

Measurement condition	Tester connection	Specified condition
Battery positive - Terminal 6 Battery negative - Terminal 5	1 - 2	Continuity

If the continuity is not as specified, replace the door lock assembly.

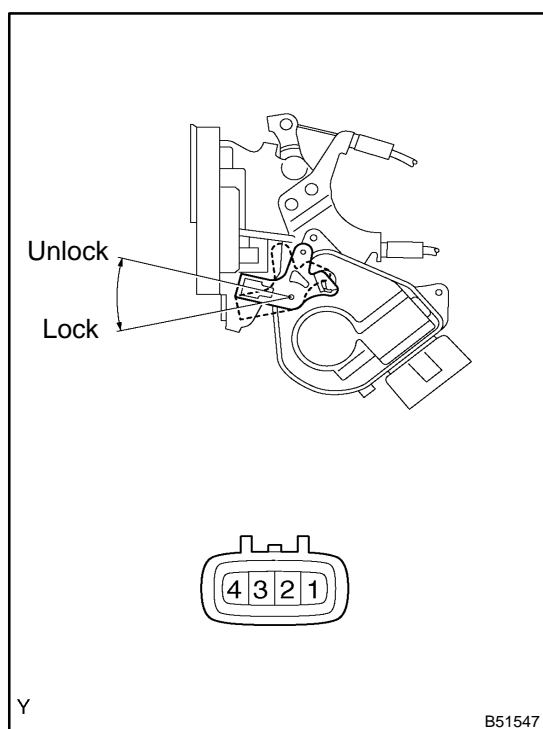

## 4. INSPECT REAR DOOR LOCK ASSY RH

## (a) Inspect operation of the door lock motor.

Measurement condition	Operation
Battery positive - Terminal 1 Battery negative - Terminal 2	Lock
Battery positive - Terminal 2 Battery negative - Terminal 1	Unlock

If operation is not as specified, replace the door lock assembly.

## (b) Inspect the position switch continuity.

Measurement condition	Tester connection	Specified condition
Battery positive - Terminal 2 Battery negative - Terminal 1	3 - 4	Continuity

If the continuity is not as specified, replace the door lock assembly.

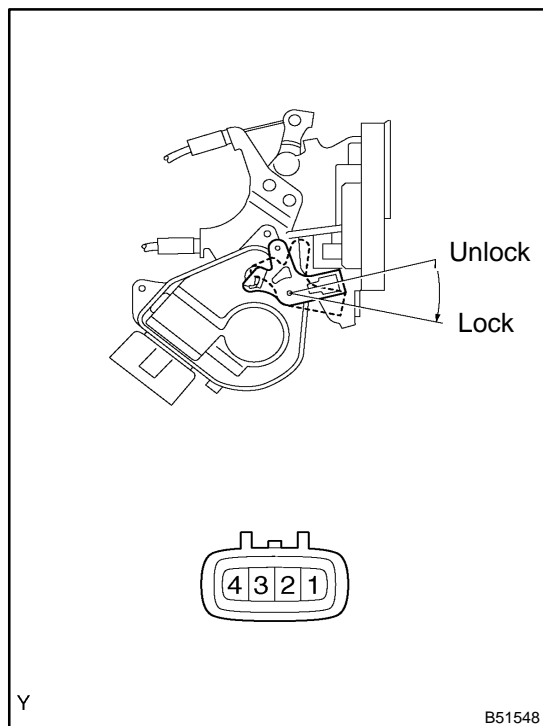

## 5. INSPECT REAR DOOR LOCK ASSY LH

(a) Inspect the operation of door lock motor.

Measurement condition	Operation
Battery positive - Terminal 1 Battery negative - Terminal 2	Lock
Battery positive - Terminal 2 Battery negative - Terminal 1	Unlock

If operation is not as specified, replace the door lock assembly.

(b) Inspect the position switch continuity.

Measurement condition	Tester connection	Specified condition
Battery positive - Terminal 2 Battery negative - Terminal 1	1 - 2	Continuity

If operation is not as specified, replace the door lock assembly.

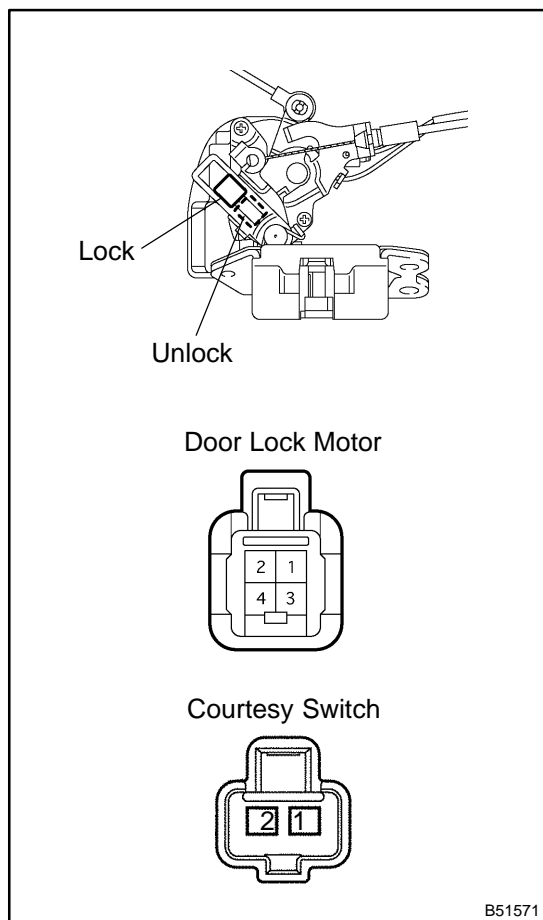

## 6. INSPECT BACK DOOR LOCK ASSY

(a) Inspect operation of the door lock motor.

Measurement condition	Operation
Battery positive - Terminal 4 Battery negative - Terminal 3	Lock
Battery positive - Terminal 3 Battery negative - Terminal 4	Unlock

If operation is not as specified, replace the door lock assembly.

(b) Inspect the back door courtesy switch continuity.

Door lock latch position	Specified condition
Open or Half Lock	Continuity
Closed	No continuity

If the continuity is not as specified, replace the door lock assembly.